

Designed specifically for the filtration of coolants, oil mist from Today's modern machine tools.

BM
Ducted Style Oil Mist Collector

BV
Direct Mount Style Oil Mist Collector



FEATURES

- Clean the Air
- Machine Fluid Savings
- Most of oil is separated, not filtered.
- Reduced Mist Exposure
- No expensive filters to replace
- Reduces Housekeeping Costs
- Easy installation & maintenance
- Compact and light weight.

BM · BV type SPECIFICATION

Hz	Type		Motor				Bore		Maxi. Discharge	Maxi. Capacity	Noise	L x W x H	Weight
	BM	BV	HP	KW	PH	V	inch	mm	mmAq	m/min	dB	mm	kg
50	BM-0532	BV-0532	1/2	0.37	3	220~440	4"	100	130	6.3	50	570x380x580	28
	BM-132	BV-132	1	0.75	3	220~440	4"	100	210	15.7	62	640x435x605	34
	BM-232	BV-232	2	1.5	3	220~440	4"	100	230	18.3	72	720x520x615	40
60	BM-0532	BV-0532	1/2	0.37	3	220~440	4"	100	150	8.5	56	570x380x580	28
	BM-132	BV-132	1	0.75	3	220~440	4"	100	240	18.3	68	640x435x605	34
	BM-232	BV-232	2	1.5	3	220~440	4"	100	300	21.5	80	720x520x615	40

APPLICATION

CNC Lathe, NC Processing, Spray coating machine, Tapping machine, Machine Center, Homing Machine

HOW THE OIL MIST IS COLLECTED

1.Pre-separation
The oil mist is sucked away from the tooling area of the machining tool through the 4 inch intake. The primary "stainless pleated cartridge" separates most of the oil mist and provides exceptional gravity drainage. The bulk of the oil is quickly removed out of the air flow and to be drained back to the machine tool through the 4 inch intake (BV type) or the 1/2 inch oil pipe drain (BM type).

2.Centrifugal
In the intermediate blower, a vortex is created by the fan rotation causing a formation of large oil drops which will easily be separate on the side plenum. Because of the gravitation, the large oil drops will again flow back to the machine tool through (another) 1/2 inch oil pipe drain located at the bottom of the side plenum

3.Final Filtration
The cleaned air is sucked by the blower and blown out through the "non-woven filter fabrics" towards the top of the unit.

STANDARD ACCESSORIES

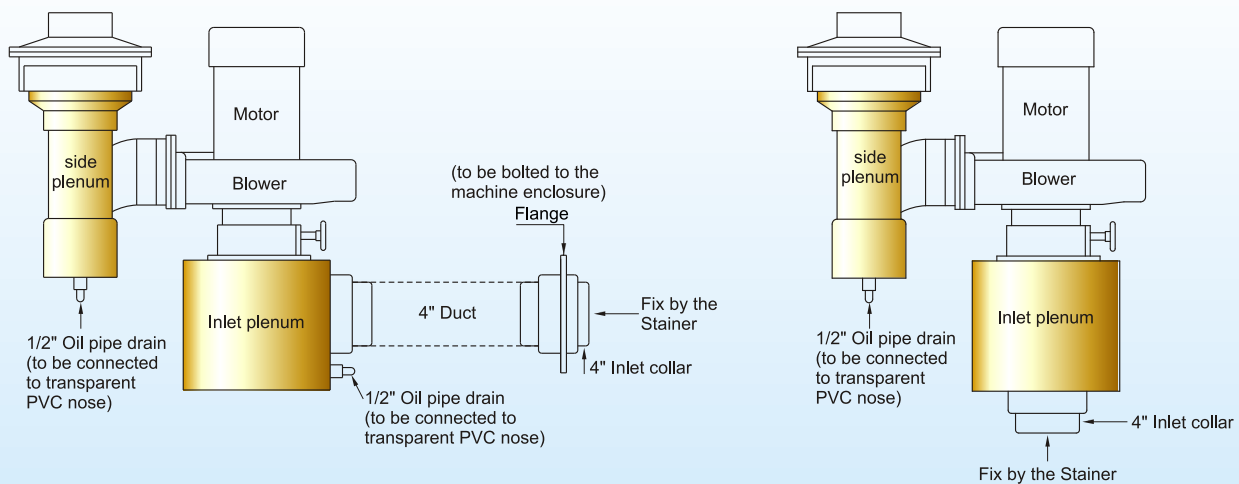

BM Type :

- Stainless pleated filter cartridge
- Non-woven Filter Fabric (10 Pcs)
- Flanged External Connector
(to be bolted to the machine enclosure)
- Strainer for the External Connector
- Transparent PVC hose (I.D.:1/2 inch)
- 90°C Elbow (2 Pcs)
- Flexible Duct
- Duct Clamp (4 Pcs)
- Hardware

BV Type :

- Stainless pleated filter cartridge
- Non-woven Filter Fabric (10 Pcs)
- Flanged Inlet Collar
- Strainer for the Inlet Collar
- Transparent PVC hose (I.D.:1/2 inch)
- Hardware



FILTRATION ELEMENT



Stainless pleated cartridge



Non-woven filter fabrics



■ DIMENSIONS

BM Type

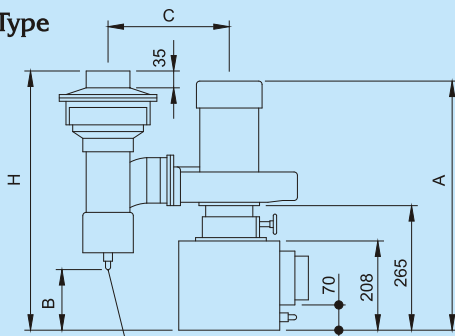

1/2" PIPE DRAIN

FRONT VIEW

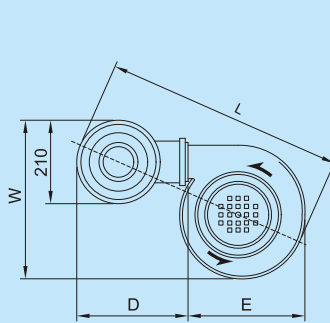

TOP VIEW

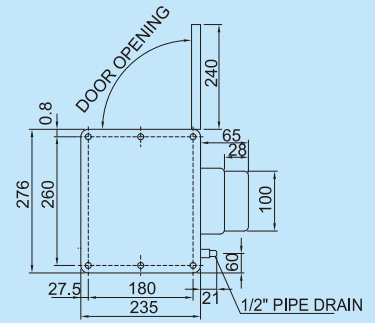

BOTTOM VIEW



FLANGE

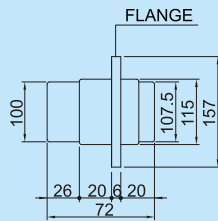

External Connector

UNIT : mm

TYPE	A	B	C	D	E	L	W	H
BM-0532	550	140	290	235	315	570	380	580
BM-132	610	155	620	240	380	640	435	605
BM-232	635	165	660	240	460	720	520	615

BV Type

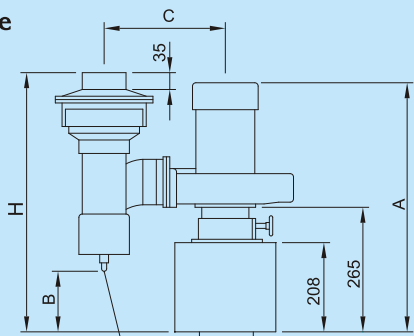

1/2" PIPE DRAIN

FRONT VIEW

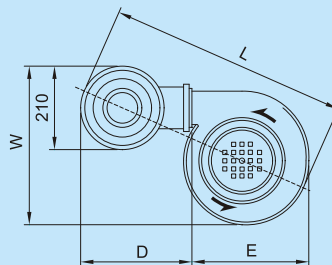

TOP VIEW

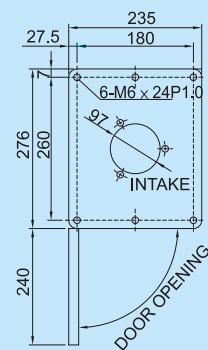

BOTTOM VIEW



FLANGE

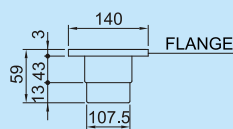

Inlet Collar

UNIT : mm

TYPE	A	B	C	D	E	L	W	H
BV-0532	550	140	290	235	315	570	380	580
BV-132	610	155	620	240	380	640	435	605
BV-232	635	165	660	240	460	720	520	615

TYPICAL DUCTED INSTALLATIONS

OIL MIST COLLECTOR

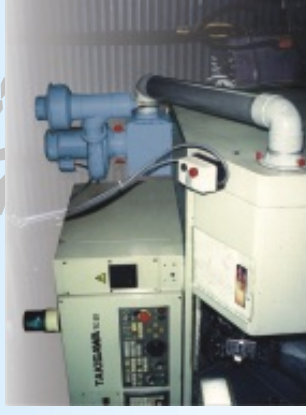
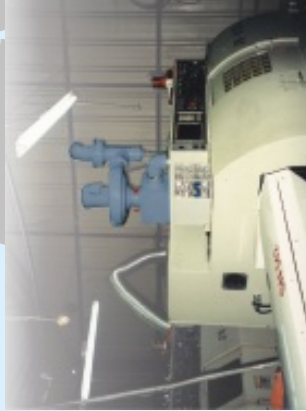

BM

